

ICBID-30CI



## FEATURES

Automatic ice maker with "max ice" feature

## ACCESSORIES

Egg Container

Crisper cover

Dual installation kits

Stainless steel front panels with tubular or pro handles

Stainless steel kickplate

Stainless Steel Pro Handles

Stainless Steel Tubular Handles

Accessories are available through an authorized dealer.  
For local dealer information, visit [subzero-wolf.com/locator](https://subzero-wolf.com/locator).



## PRODUCT DETAILS

### REFRIGERATOR

- 2 Temperature Zones

### FREEZER

- Automatic ice maker

**PRODUCT SPECIFICATIONS**

Model	ICBID-30CI
Dimensions	762mmW x 876mmH x 610mmD
Refrigerator Capacity	87 L
Freezer Capacity	58 L
Door Clearance	451mm
Drawer Clearance	451mm
Weight	95 kg
Electrical Supply	220-240 VAC; 50/60 Hz
Electrical Service	≤ 2 A
Plumbing Supply	6.35 mm OD copper line, braided stainless steel or PEX tubing
Plumbing Pressure	2.4-8.3 bar
Receptacle	3-prong grounding-type

**ELECTRICAL**

**PLUMBING**

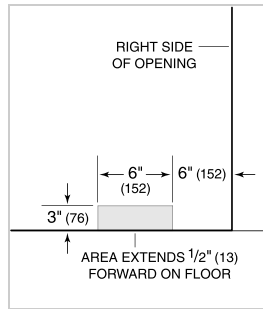
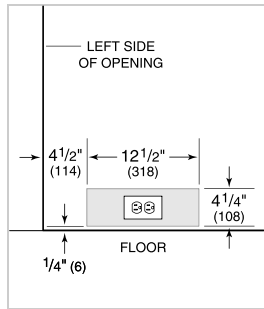

NOTE: Dimensions in parenthesis are in millimeters unless otherwise specified

**INTERIOR VIEW**

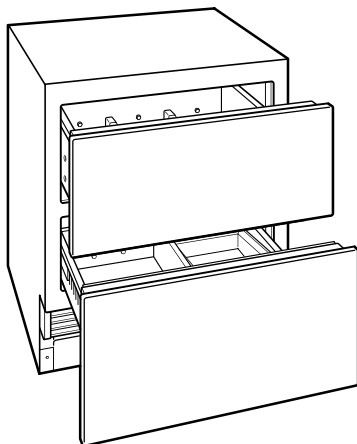

This illustration is intended for interior reference only and may not represent the exterior of the model being specified.

**DIMENSIONS**

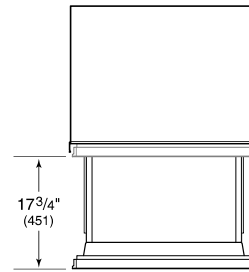
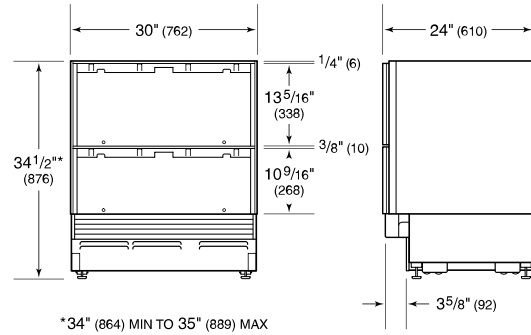

**STANDARD INSTALLATION**

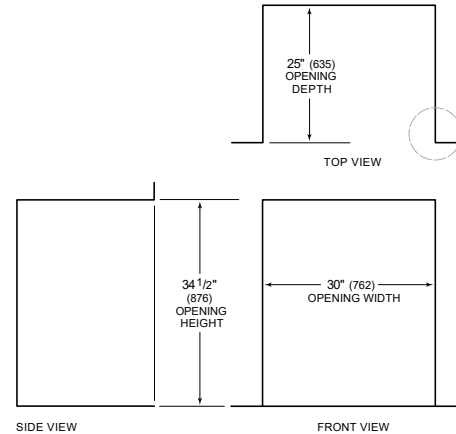

NOTE: 3 1/2" (89) finished returns will be visible and should be finished to match cabinetry

