

**ICBCSO30PE/S/PH**

**FEATURES**

Rigorously tested for decades of use

Exceptional support from our Customer Care team

Gourmet mode adjusts time, temperature, humidity for perfect results

Larger than similar units, can make multiple dishes at once

Program in when you want your dish to be ready

Easy-access water tank provides 90 minutes of steam cooking

Temperature probe cooks to ideal doneness and lets you know when it's ready



**PRODUCT SPECIFICATIONS**

|                          |                          |
|--------------------------|--------------------------|
| Model                    | ICBCSO30PE/S/PH          |
| Dimensions               | 759mmW x 454mmH x 546mmD |
| Oven Interior Dimensions | 454mmW x 279mmH x 400mmD |
| Capacity                 | 51 L                     |
| Door Clearance           | 360mm                    |
| Weight                   | 36 kg                    |
| Electrical Supply        | 220-240 VAC; 50 Hz       |
| Electrical Service       | 3800 W                   |

**ELECTRICAL**

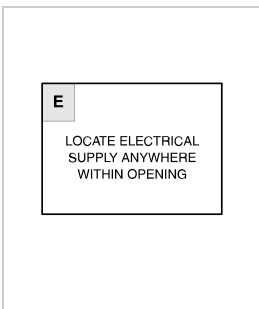

**NOTE:** Dimensions in parenthesis are in millimeters unless otherwise specified

**DIMENSIONS**

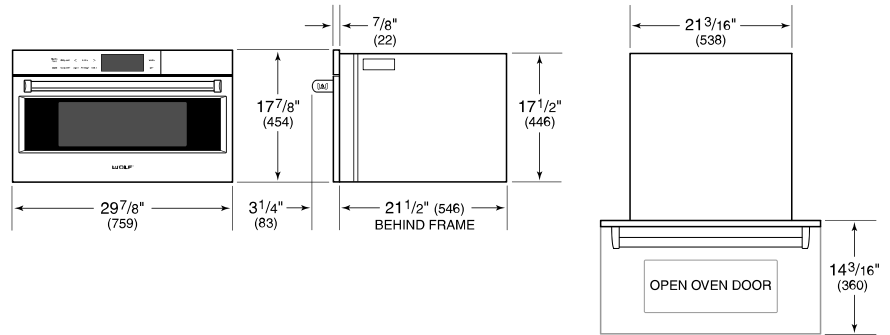

**STANDARD INSTALLATION**

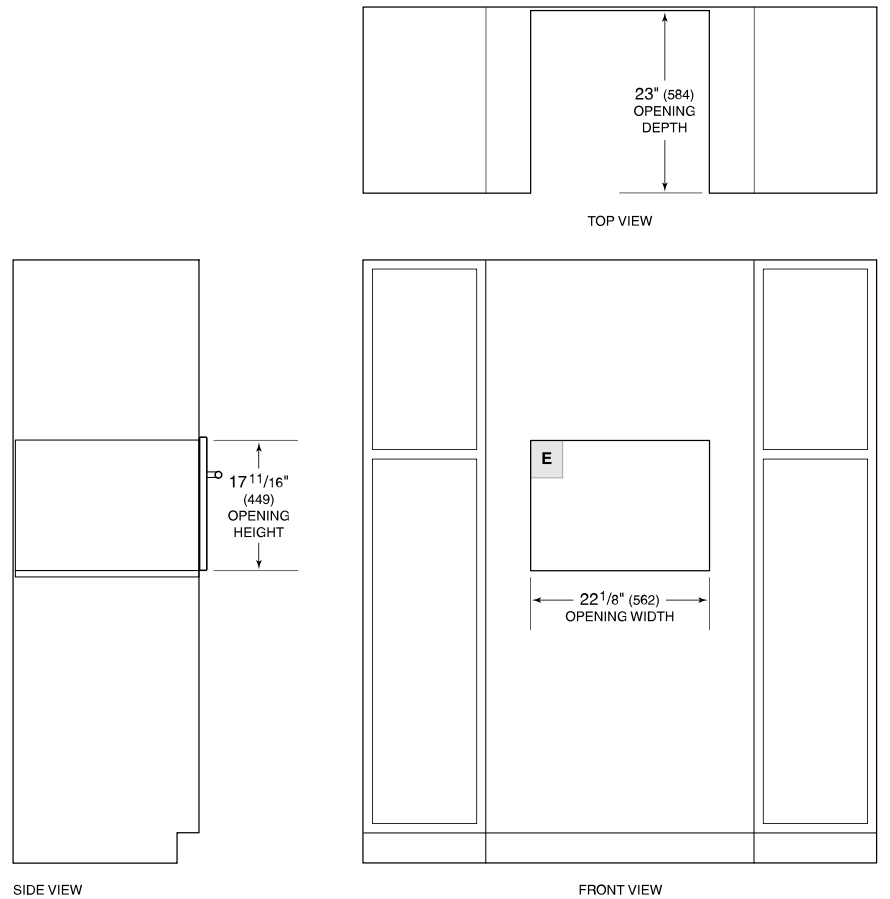

SIDE VIEW

FRONT VIEW

**NOTE:** 24" (610) and 30" (762) models require the same opening dimensions.