

**SUB\*ZERO**

**DESIGN GUIDE**

**PRO 48 SERIES**



**EFFECTIVE 1/4/2017**

## TABLE OF CONTENTS

---

3	PRO 48 REFRIGERATION
8	SUB-ZERO WARRANTIES



Features and specifications are subject to change at any time without notice.

Throughout this guide, dimensions may vary by  $\pm 3$  mm.

### PRO 48 Refrigeration

Freshness finds unmistakable expression in the Sub-Zero PRO 48. A 363 kg monument to food preservation—equal parts sculpted metal design statement and culinary secret weapon. Its vast interior, like its bold exterior, is crafted of stainless steel. The PRO 48 is available with or without a glass door and may be either built in or freestanding.

### PRO 48 MODELS

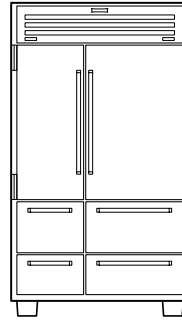

ICB648PRO

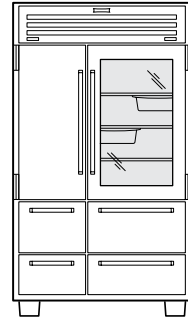

ICB648PROG

PRO 48 REFRIGERATION

Overall Dimensions

PRO 48 MODELS

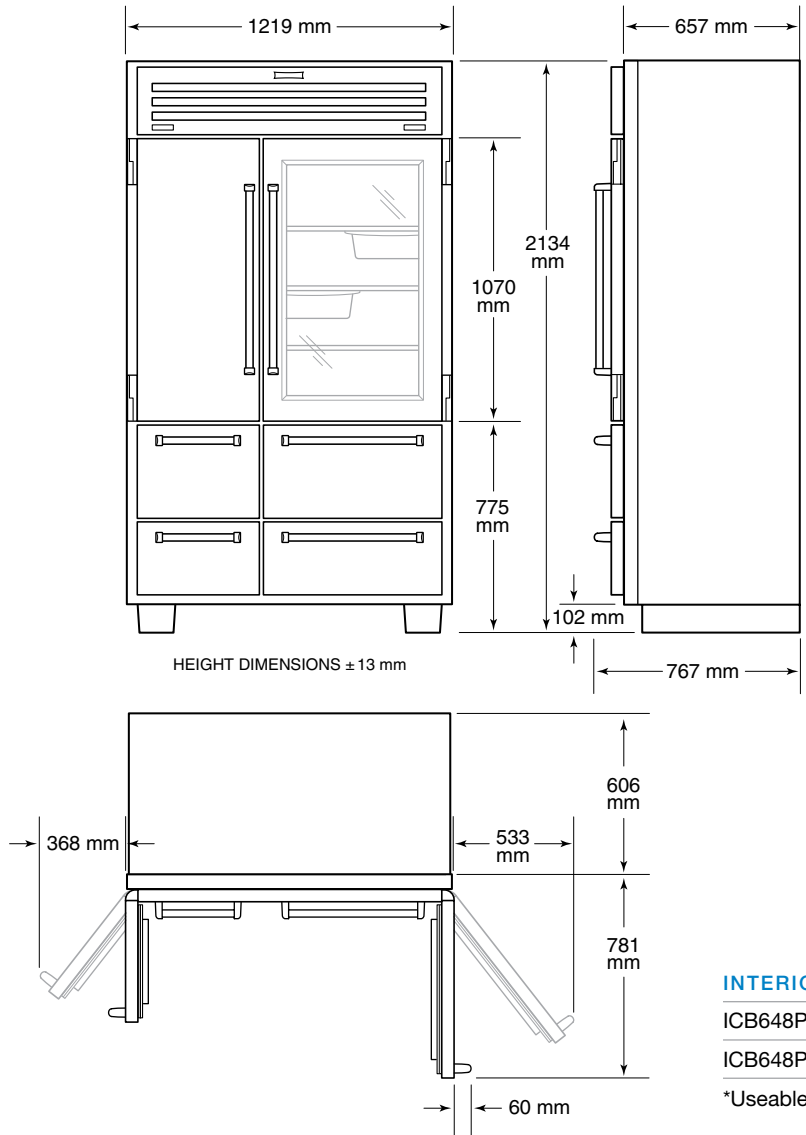

INTERIOR CAPACITY	R (L)*	F (L)*
ICB648PRO	521	331
ICB648PROG	521	331

\*Useable volume based on ISO 15502.

Models ICB648PRO, ICB648PROG.

## Opening Dimensions

### STANDARD | FLUSH INSTALLATION

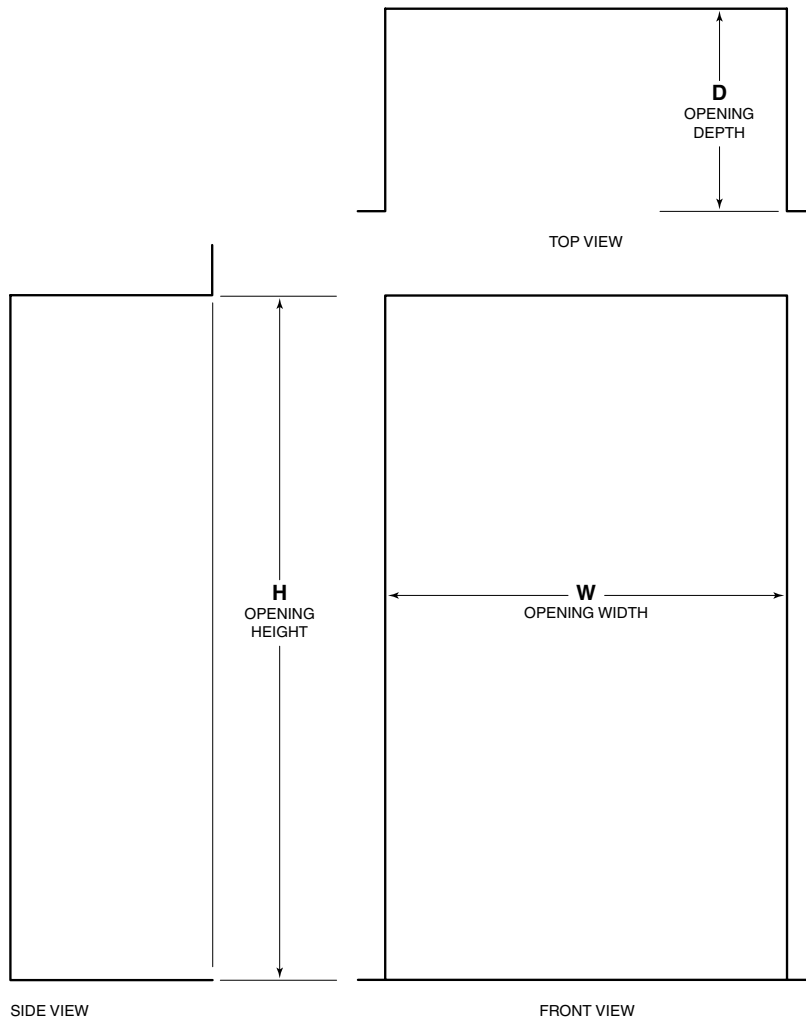

OPENING DIMENSIONS	W	H	D
Standard	1206 mm	2127 mm	620 mm
Flush	1219 mm	2137 mm	670 mm

For standard built-in installations, the face frame of the unit will extend 51 mm beyond cabinetry. For flush installations, the front of the face frame will be flush with surrounding cabinetry.

### Planning Information

PRO 48 models can be used freestanding or installed as a standard or flush built-in application. For standard built-in installations, the face frame of the unit will extend 51 mm beyond cabinetry. In flush built-in installations, the front of the face frame will be flush with surrounding cabinetry.

#### ELECTRICAL REQUIREMENTS

International models from the factory designed without a transformer require a 220-240 V AC, 50/60 Hz electrical supply, fused at the correct rating for the unit. If required by local or national codes, the power cord can be easily replaced using the power inlet device.

For Pro 48 models the electrical supply should be either in the cabinet above the refrigerator a MINIMUM OF 2200mm ABOVE THE FLOOR or in the cabinet alongside. If freestanding then locate the power point as per the diagram below. A separate circuit, servicing only this appliance, is required. A ground fault circuit interrupter (GFCI) is not recommended and may cause interruption of operation.

Electrical Requirements	
Power Supply	220-240 V AC, 50/60 Hz
Circuit Breaker	10 amp
Receptacle	3-prong grounding-type

#### PLUMBING REQUIREMENTS

PRO 48 models come with an automatic ice maker, a pressure limiting valve and 5 meters of flexible 6mm pipe with fittings is included in the refrigerator carton. Connect the pressure limiting valve close to the water tap, CHECKING THE WATER FLOW IS IN THE RIGHT DIRECTION. Ensure water connection is 1/2" BSP male threaded outlet. Fix the 6mm water line to the wall and floor to ensure it isn't squashed when the refrigerator is pushed into the cavity. Locate the water tap either in the cabinet above a minimum of 2200mm from the floor, or in the cabinet alongside.

The water line must not interfere with installation of the anti-tip brackets.

**IMPORTANT NOTE:** A reverse osmosis system can be used provided there is constant water pressure of 2.1 bar to 6.9 bar supplied to the unit at all times.

Plumbing Requirements	
Water Supply Line	6mm plastic line
Water Pressure	2.1-6.9 bar
Water Line for Connection	5m

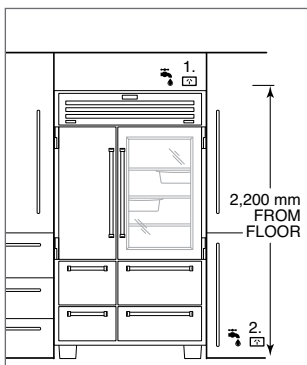

Pro 48. Alternative location of power & water supply depending on ease of access.

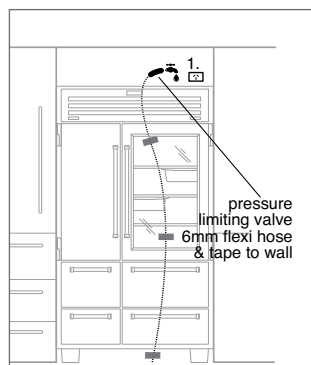

1. Pro 48. Water supply above fridge. Location of 6mm flexible hose. Tape to wall and floor with pressure limiting valve next to tap.

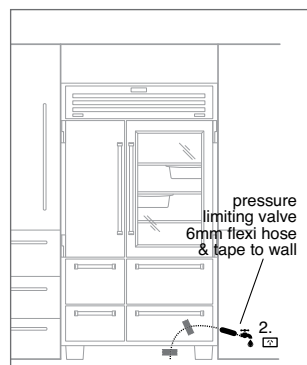

2. Pro 48. Water supply beside fridge. Location of 6mm flexible hose. Tape to wall and floor with pressure limiting valve next to tap.

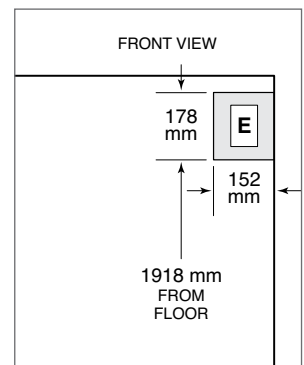

Freestanding location of power supply.

### Standard Handles

Refer to the chart below for standard handle lengths for PRO 48 models.

HANDLE LENGTH	TUBULAR	PRO
Door	NA	703 mm
Refrigerator Drawer	NA	506 mm
Freezer Drawer	NA	294 mm

## Sub-Zero International Limited Warranty

FOR RESIDENTIAL USE

### FULL TWO YEAR WARRANTY\*

For two years from the date of original installation, this Sub-Zero product warranty covers all parts and labor to repair or replace, under normal residential use, any part of the product that proves to be defective in materials or workmanship. All service provided by Sub-Zero under the above warranty must be performed by Sub-Zero factory certified service, unless otherwise specified by Sub-Zero, Inc. Service will be provided during normal business hours.

### FULL FIVE YEAR SEALED SYSTEM WARRANTY

For five years from the date of original installation, this Sub-Zero product warranty covers all parts and labor to repair or replace, under normal residential use, these parts that prove to be defective in materials or workmanship: compressor, condenser, evaporator, drier and all connecting tubing. All service provided by Sub-Zero under the above warranty must be performed by Sub-Zero factory certified service, unless otherwise specified by Sub-Zero, Inc. Service will be provided during normal business hours.

For more information regarding your Sub-Zero product warranty, contact your authorized Sub-Zero dealer. Warranties must comply to all country, state, city, local and or ordinance.

\*Stainless steel (doors, panels, handles, product frames and interior surfaces) are covered by a limited 60-day parts and labor warranty for cosmetic defects.

\*Replacement water filters and air purification cartridges are not covered by the product warranty.



Sub-Zero, Sub-Zero & Design, Sub-Zero & Snowflake Design, Dual Refrigeration, The Living Kitchen, Great American Kitchens The Fine Art of Kitchen Design, Wolf, Wolf & Design, Wolf Gourmet, W & Design, red colored knobs, Cove, and Cove & Design, are registered trademarks and service marks of Sub-Zero Group, Inc. and its subsidiaries. All other trademarks are property of their respective owners in the United States and other countries.





SUB-ZERO GROUP AUSTRALIA PTY LTD

Bank House, 11 – 19 Bank Place.  
Melbourne Victoria Australia 3000  
Telephone 03 9600 2218

[enquiries@subzero.com](mailto:enquiries@subzero.com)



[SUBZERO-WOLF.COM.AU](http://SUBZERO-WOLF.COM.AU)