

ICBSO30CM/B



FEATURES

Black glass, handleless design for Wolf performance at its sleekest

Advanced Dual VertiCross convection system for faster preheats and consistent cooking across all racks

Gourmet feature has menu of presets that automatically controls cooking of popular meals

Interactive color touchscreen for advanced cooking control

Enhanced interior views with triple-pane glass and three halogen lights

Quiet-close doors with spring-and-damper door hinge system

Can be installed flush with surrounding cabinetry for integrated look

145 L capacity to handle multiple dishes at once

10 cooking modes for predictably delicious results (Convection, Roast, Bake, Grill, Convection Roast, Stone, Gourmet, Warm, Proof and Dehydrate)

Rigorously tested in our U.S. manufacturing facilities for decades of use

Exceptional support from our Customer Care team



PRODUCT SPECIFICATIONS

Model	ICBSO30CM/B
Dimensions	759mmW x 724mmH x 584mmD
Oven 1 Interior Dimensions	641mmW x 448mmH x 506mmD
Overall Capacity	145 L
Door Clearance	543mm
Weight	124 kg
Electrical Supply	220-240 VAC; 50/60 Hz
Electrical Service	4.2-4.8 kW

DIMENSIONS

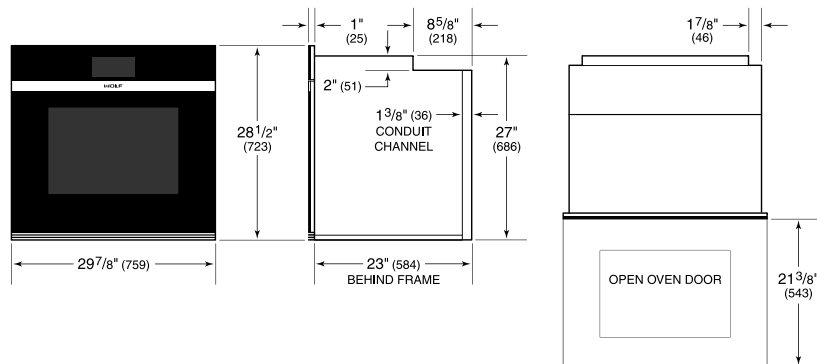

ELECTRICAL

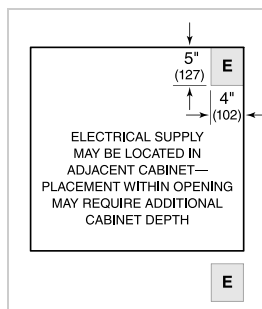

NOTE: Dimensions in parenthesis are in millimeters unless otherwise specified

STANDARD INSTALLATION

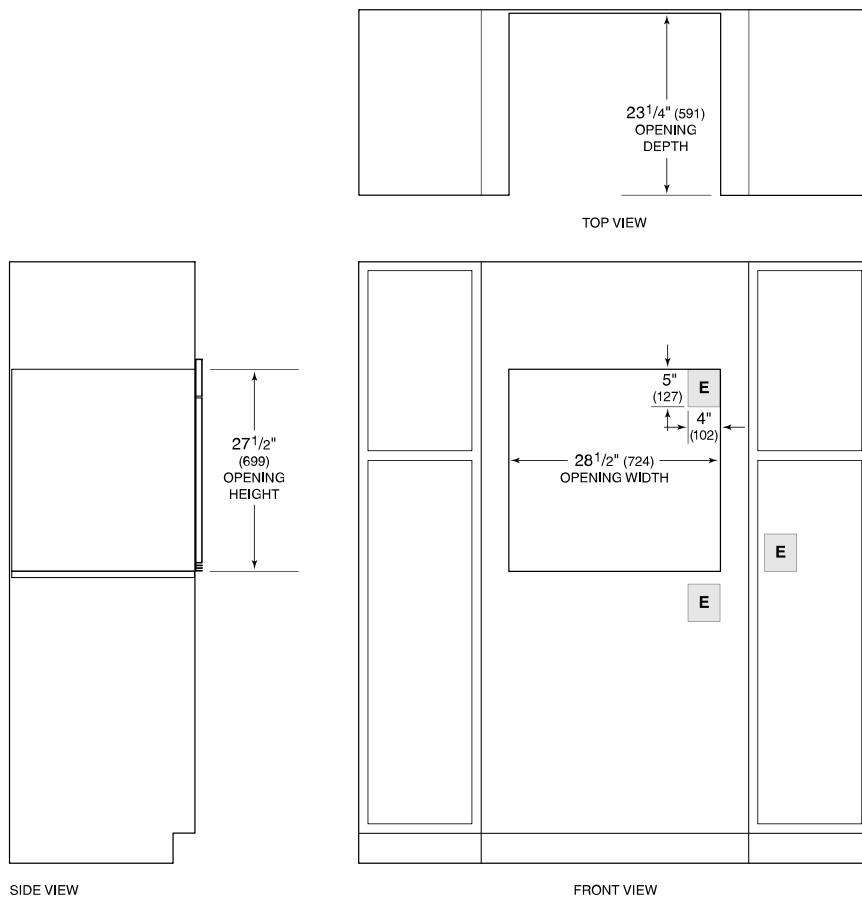

NOTE: Location of electrical supply within opening may require additional cabinet depth.