

ICBMDD24TE/S/TH

**FEATURES**

Integrates into any kitchen

Matches E series ovens, coffee systems, convection steam oven

900 watts of power

Quick-start controls for popular items

Gourmet mode cooks automatically from preset recipes

"Keep Warm" mode

Generous 45 litres. capacity

Rigorously tested for decades of use

Exceptional support from our Customer Care team

**ACCESSORIES**

Pro Handle

Accessories available through an authorized dealer.

For local dealer information, visit [subzero-wolf.com/locator](http://subzero-wolf.com/locator).



**PRODUCT SPECIFICATIONS**

|                    |                          |
|--------------------|--------------------------|
| Model              | ICBMDD24TE/S/TH          |
| Dimensions         | 597mmW x 454mmH x 508mmD |
| Capacity           | 46 L                     |
| Door Clearance     | 360mm                    |
| Weight             | 36 kg                    |
| Electrical Supply  | 220-240 VAC; 50/60 Hz    |
| Electrical Service | 900 W                    |

**ELECTRICAL**

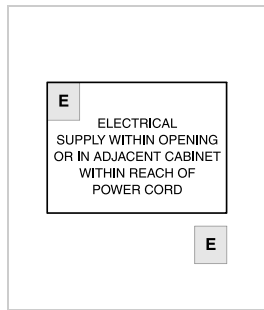

**NOTE:** Dimensions in parenthesis are in millimeters unless otherwise specified

**DIMENSIONS**

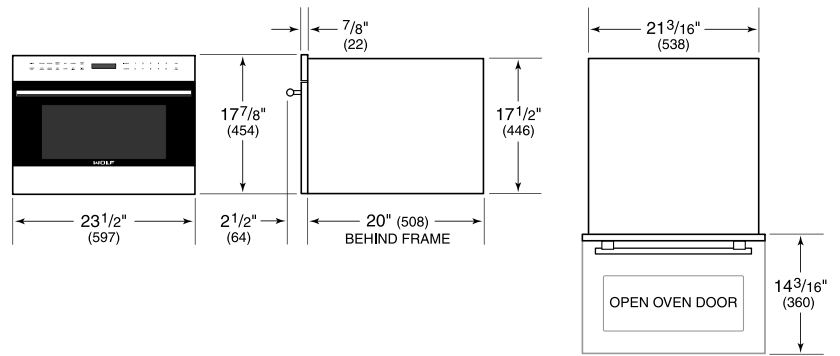

**FLUSH INSTALLATION**

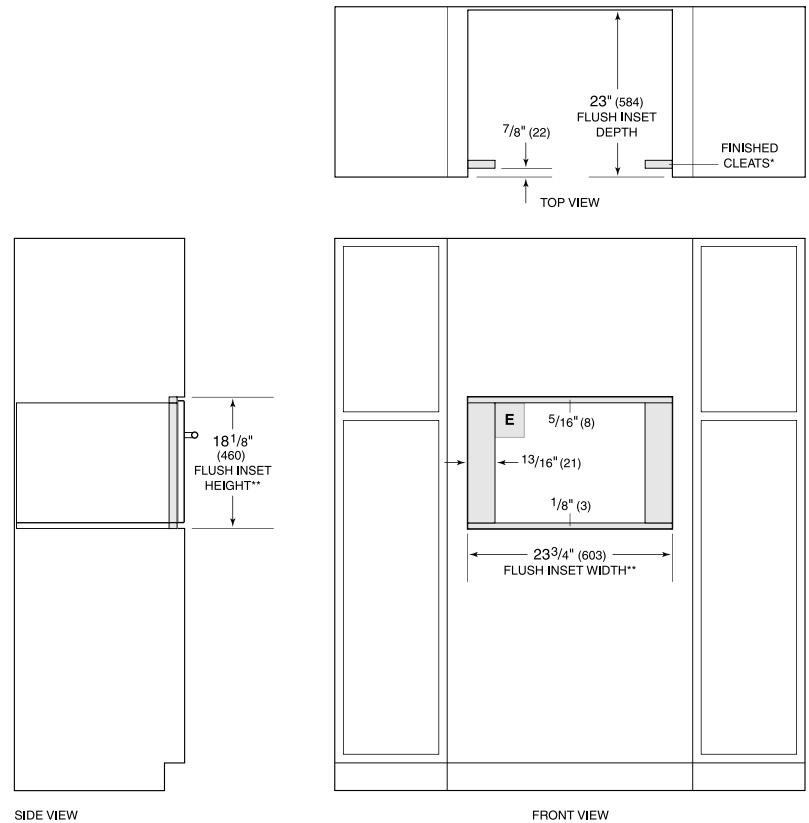

\*Will be visible and should be finished to match cabinetry.  
 \*\*Dimension provides minimum reveals.