



ICBSPO24TE/S/TH

FEATURES

- Combines microwave, convection, and grill technologies to provide all-in-one oven versatility
- Provides more cooking power than a traditional microwave with the help of convection and grill
- Assures predictably delicious results with 10 microwave power levels, convenient quick-start modes, and an intuitive Gourmet mode
- Fits a 33x23cm pan in the 46 L, stainless-steel interior
- Micro Bake and Micro Roast modes reduce or completely eliminate preheat times
- Frees up counter space with efficient drop-down door design
- Coordinates with other Wolf built-in ovens and appliances with various handle and trim options

ACCESSORIES

- Pro Handle
- Accessories available through an authorized dealer.
For local dealer information, visit subzero-wolf.com/locator.



PRODUCT SPECIFICATIONS

Model	ICBSPO24TE/S/TH
Dimensions	597mmW x 454mmH x 546mmD
Capacity	46 L
Door Clearance	360mm
Weight	36 kg
Electrical Supply	grounded, 230 VAC, 50 Hz
Electrical Service	15 amp dedicated circuit
Power Cord Length	1.8 Meters
Receptacle	grounding-type (earthed), IEC inlet

ELECTRICAL

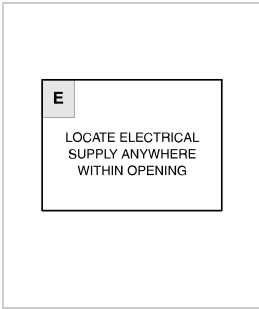

NOTE: Dimensions in parenthesis are in millimeters unless otherwise specified

DIMENSIONS

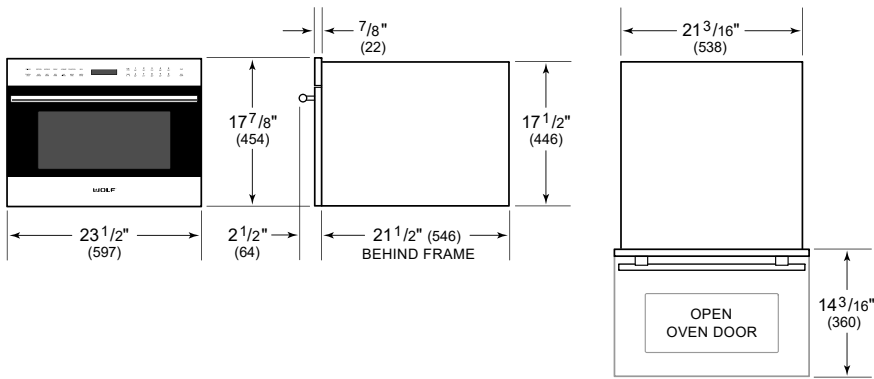

STANDARD INSTALLATION

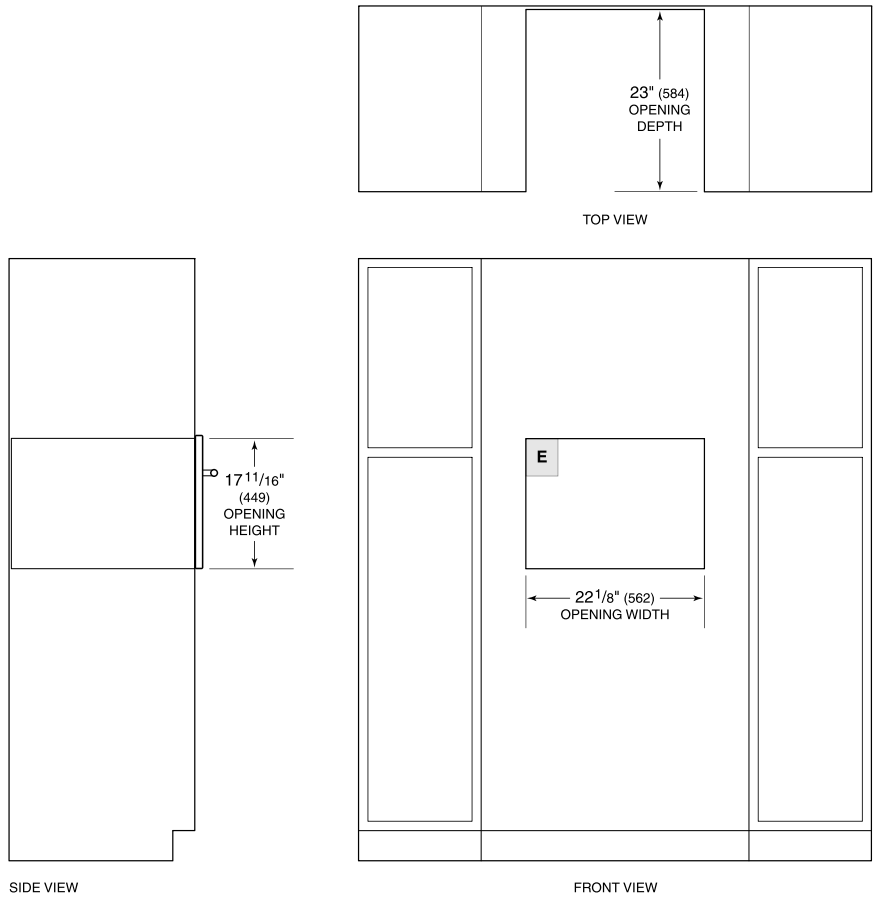

NOTE: 24" (610) and 30" (762) models require the same opening dimensions.